

ROUTE 100 WWTP EXPANSION UPDATES

Upper Uwchlan Township Municipal Authority
Wastewater Treatment Systems
March 26, 2024



MEETING OVERVIEW

- ❖ **INTRODUCTIONS**
 - **AUTHORITY BOARD**
 - **TOWNSHIP**
 - **STAFF & CONSULTANTS**

Neighborhoods Map

Upper Uwchlan Township
Chester County, Pennsylvania

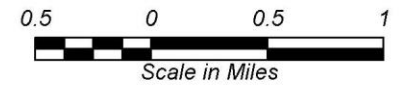

LEGEND

- Township Boundaries
- Tax parcels
- Roads
- Streams
- Water Bodies



Brandywine Conservancy
Environmental Management Center
P.O. Box 141 Chadds Ford, Pennsylvania 19317 (610) 388-2700

Revised: October 20, 2005

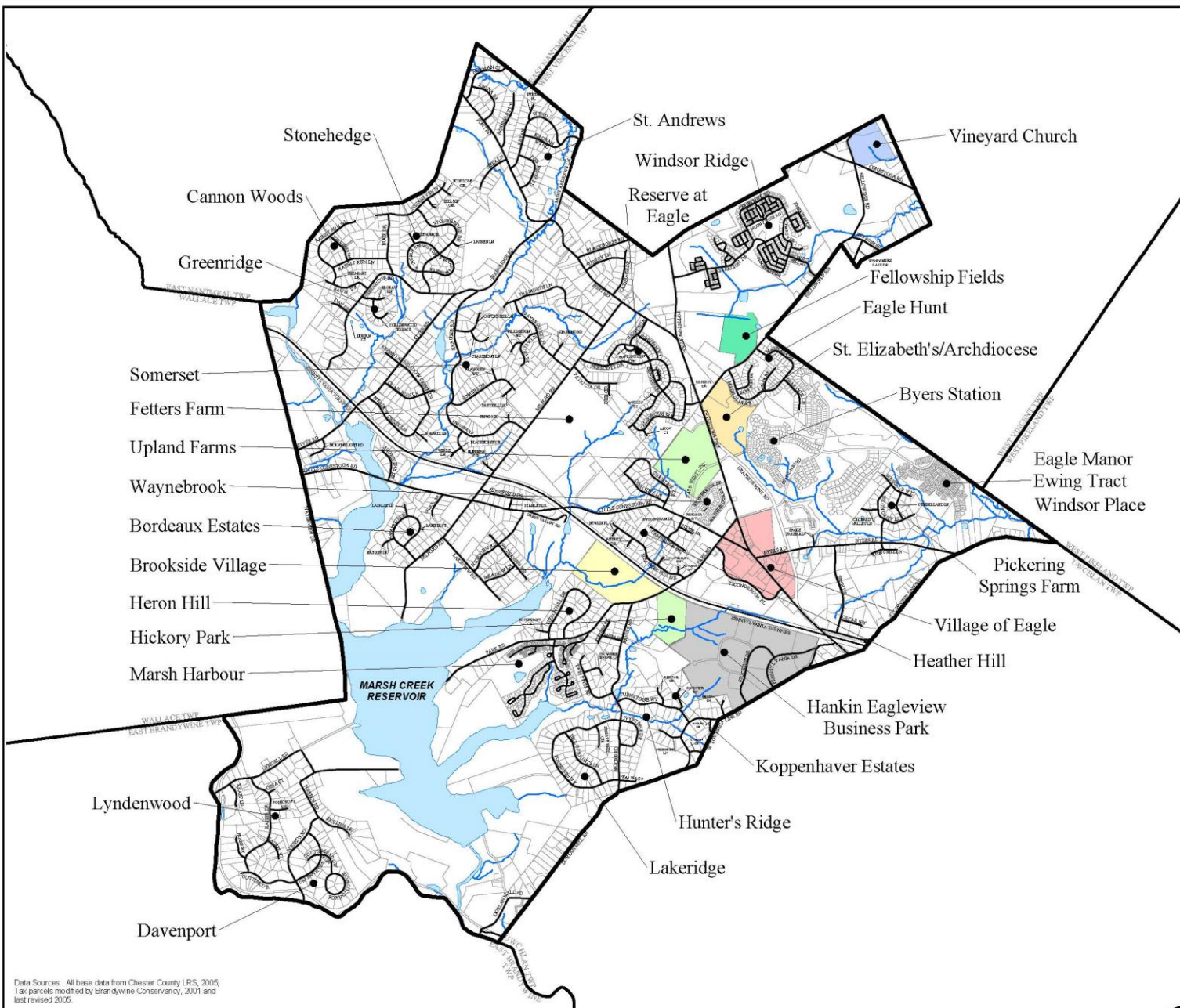

Data Sources: All base data from Chester County LPS, 2005.
Tax parcels modified by Brandywine Conservancy, 2001 and
last revised 2005.

MILFORD FARMS

EAST NANTMEAL
TOWNSHIP

MEADOW CREEK

WEST VINCENT TOWNSHIP

EAGLEPOINTE

WEST PIKELAND TOWNSHIP

WALLACE TOWNSHIP

EAST BRANDYWINE
TOWNSHIP

UWCHLAN TOWNSHIP

MOORE ROAD

(PART OF MILFORD FARMS PROJECT)

**UPPER UWCHLAN TOWNSHIP
MILFORD FARMS
MEADOW CREEK AND
EAGLEPOINTE
SANITARY SEWER EXTENSION**



1450 E BOOT ROAD
BUILDING 100
WEST CHESTER, PA 19380
(717) 569-7021

SCALE:
0 800' 1200' 2400' 3600'
SCALE: 1" = 1200'

DATE:
03/01/24

DWG NO.:
10270.64

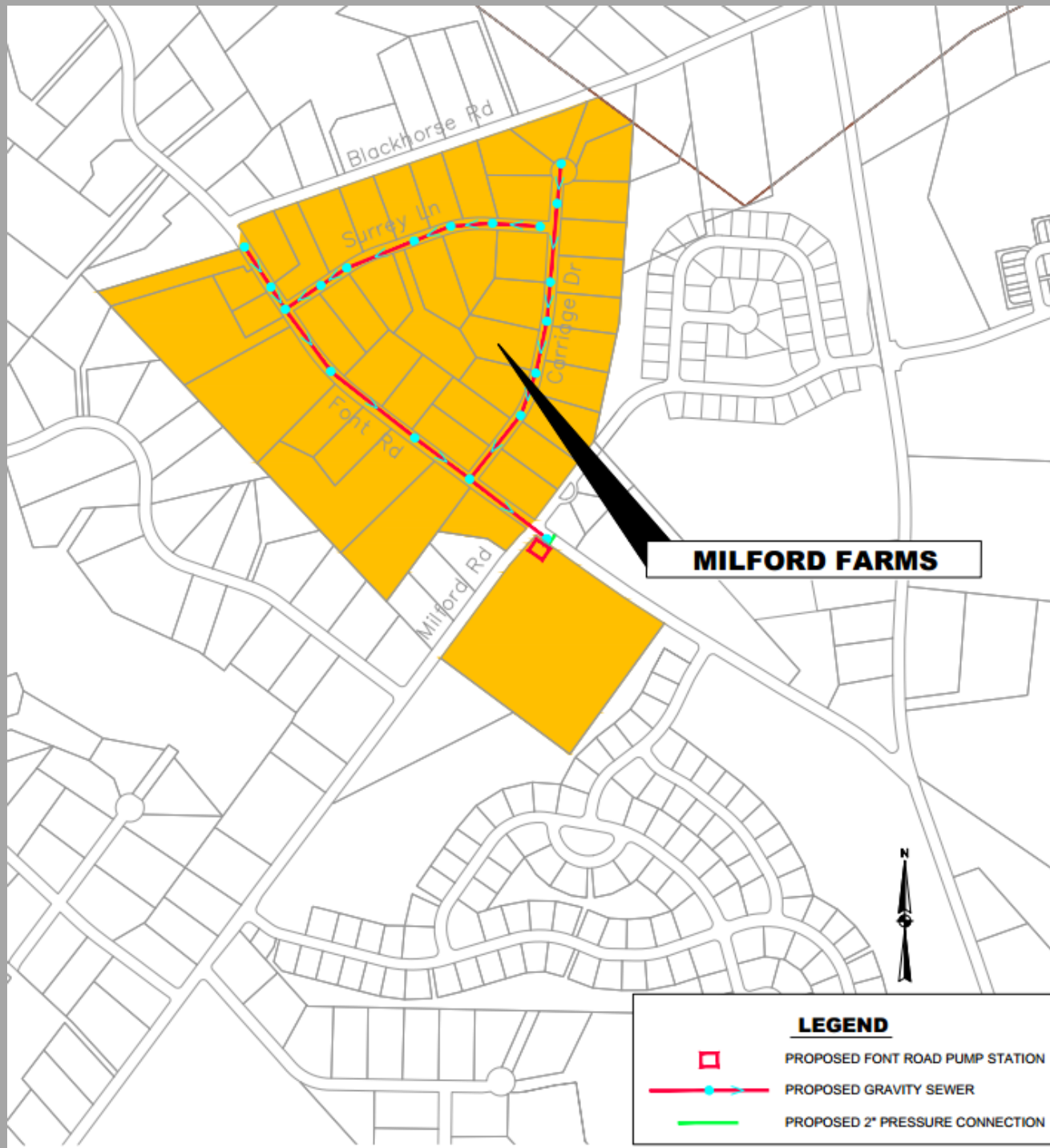

- SERVING ~50 HOUSES
- ~4,400 feet of 8" pipe
- ~19 manholes
- Curb restoration
- Re-Pave Road

MILFORD FARMS OVERVIEW

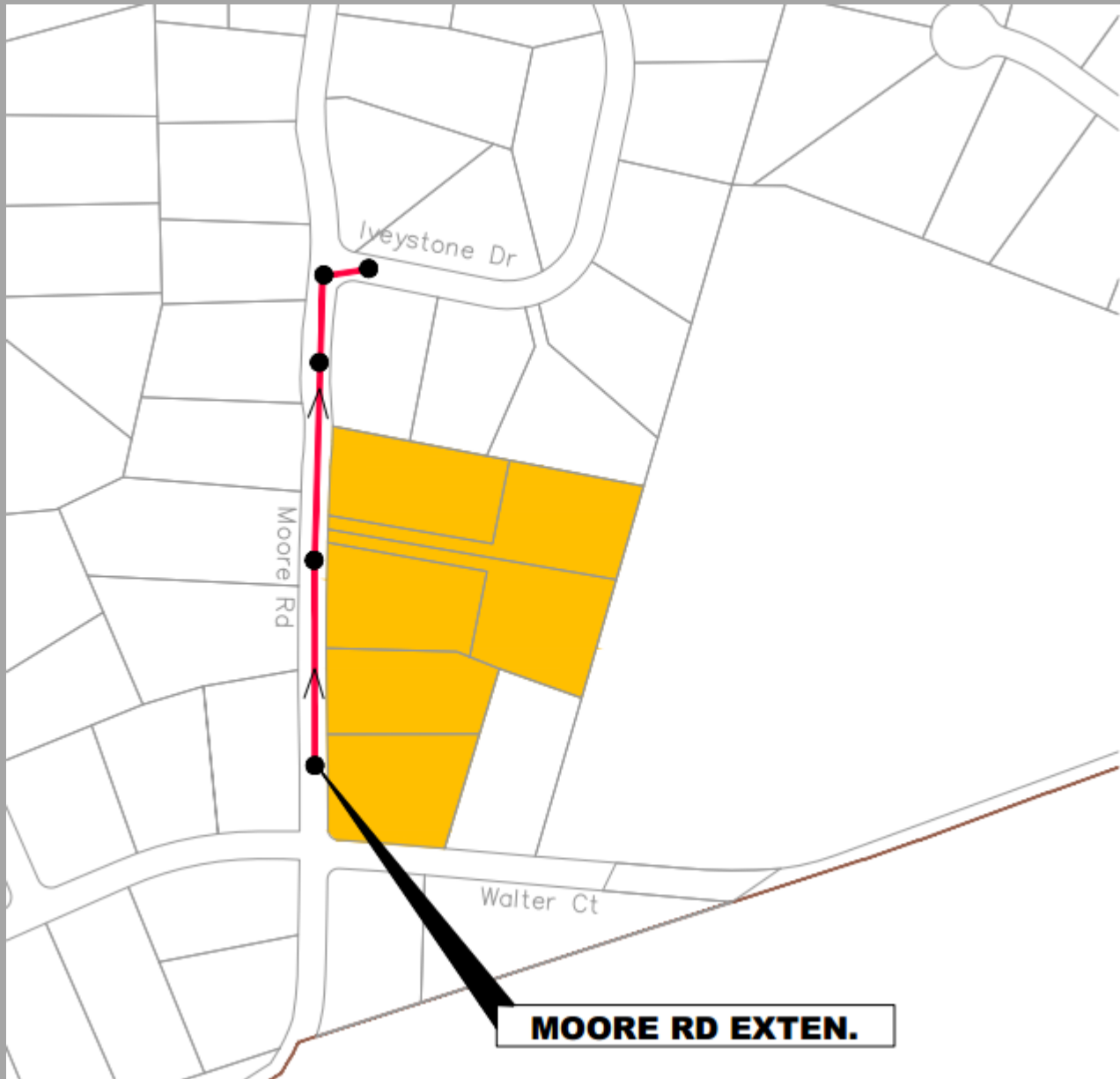

- SERVING 6 HOUSES
- ~900 feet of 8" pipe
- ~4 manholes
- Curb restoration
- Re-Pave Road

MOORE ROAD OVERVIEW

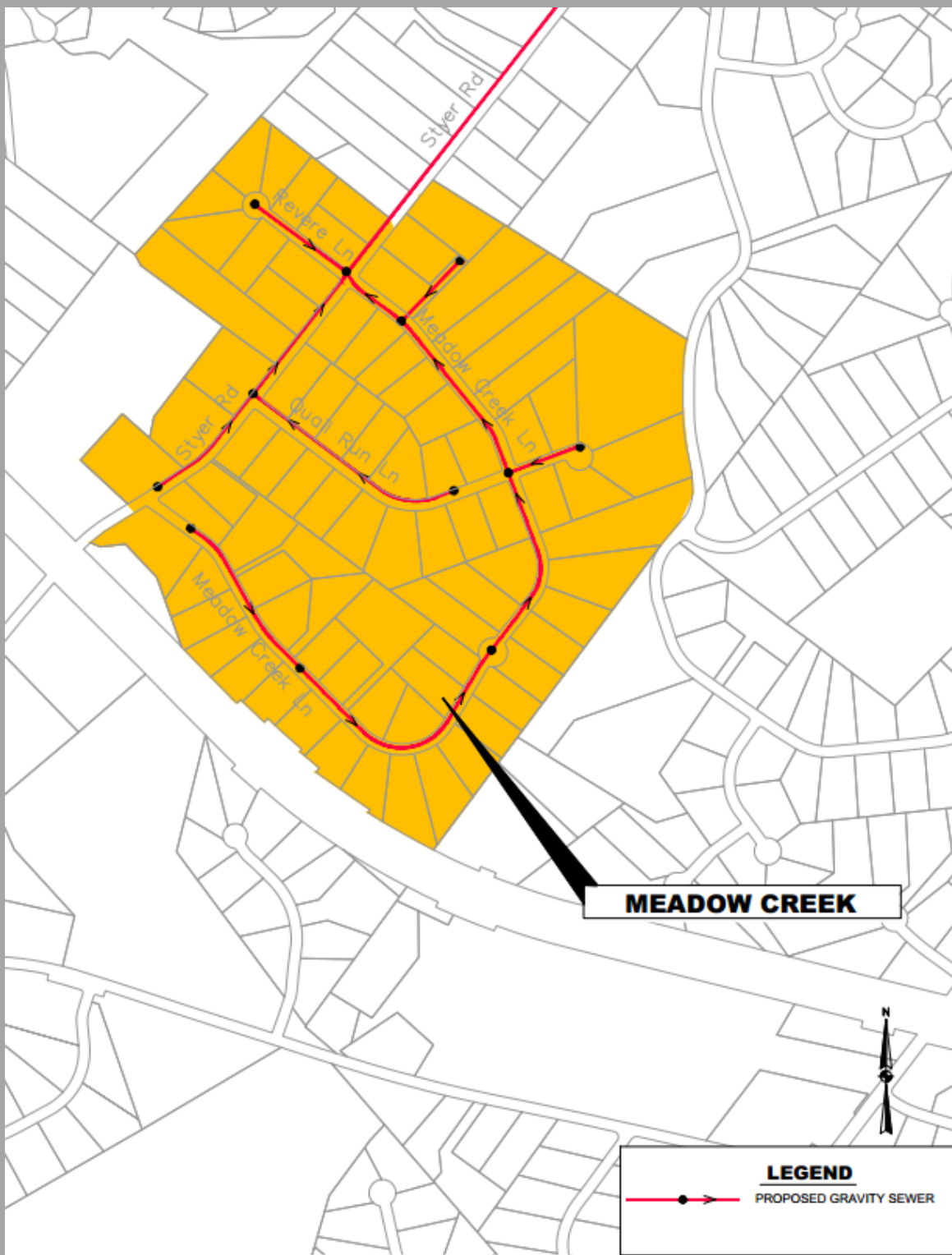

- SERVING ~80 HOUSES
- Decommission WWTP
- ~4,000 feet of 2" pipe
- ~5,500 feet of forcemain
- Curb restoration
- Road Repairs

MEADOW CREEK OVERVIEW

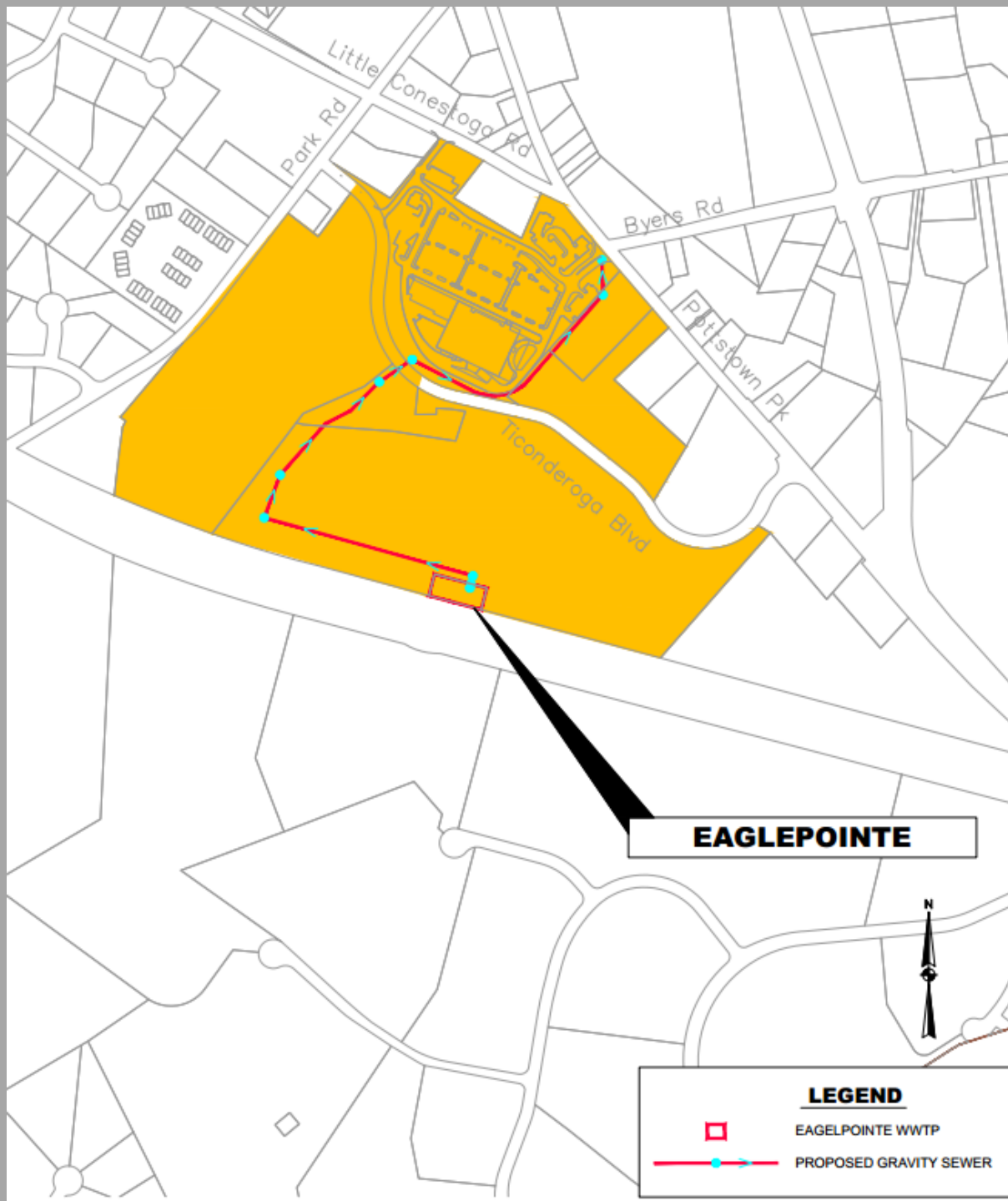

- SERVING multiple existing businesses.
- Will be able to accommodate additional connections
- Plant Decommission
- No Stream Discharge
- ~3,000 feet of forcemain

EAGLEPOINTE OVERVIEW

WORK TO INCLUDE...

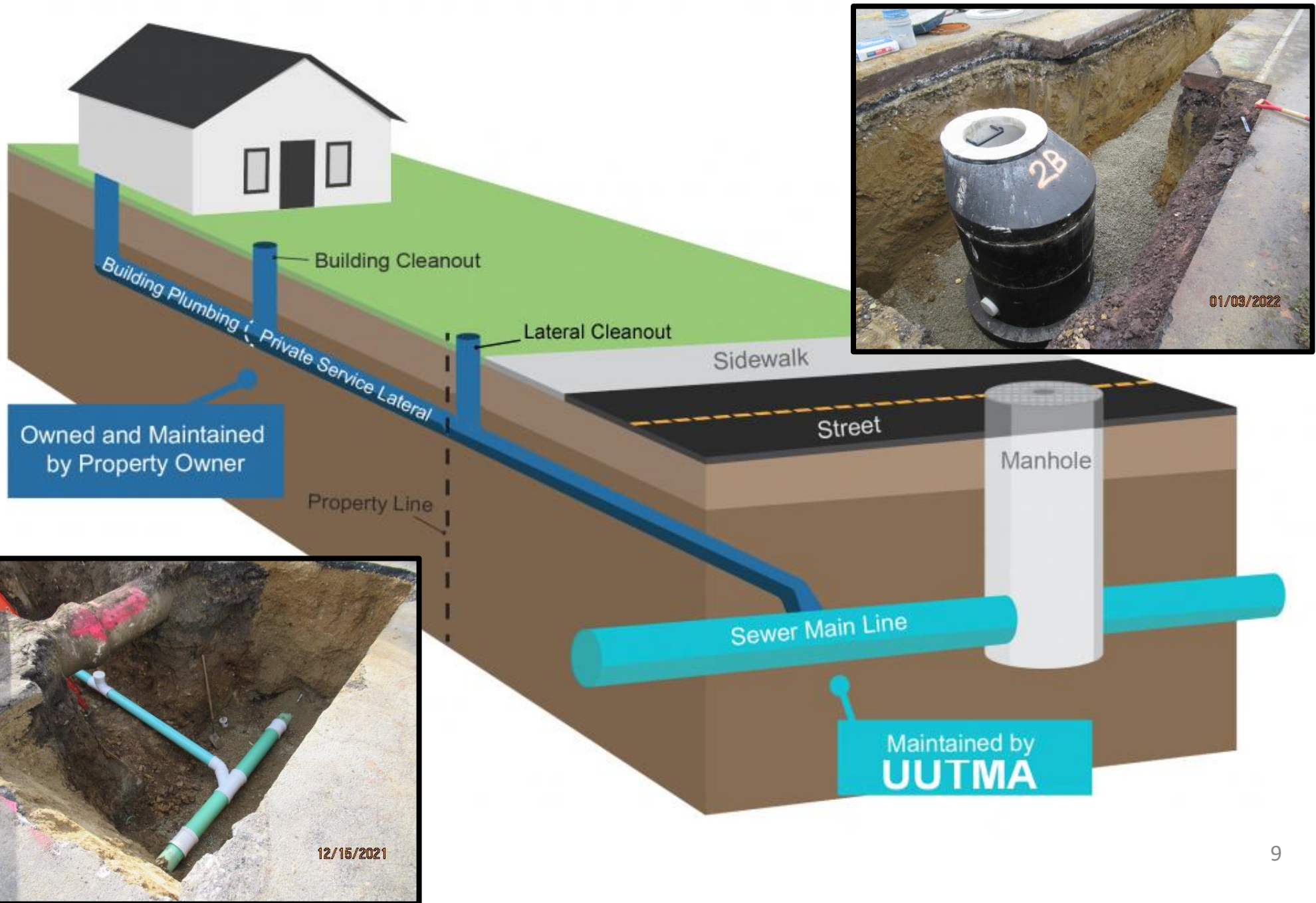

FUNDING

- BUDGET
- GRANTS
- RESIDENTS



ESTIMATED COSTS

- MILFORD FARMS: \$3,248,000 (Grant of \$1,035,000)
- MEADOW CREEK: \$3,040,00 (no Grants)
- EAGLEPOINTE: \$520,000 (Grant of \$259,000)

COST APPORTIONMENT

- Mains, Manholes, Pump Stations, Etc
Wholly funded by UUTMA
- Property Laterals, Connection Fees, Tank
Demo funded by Property Owner*

*with exception of Meadow Creek

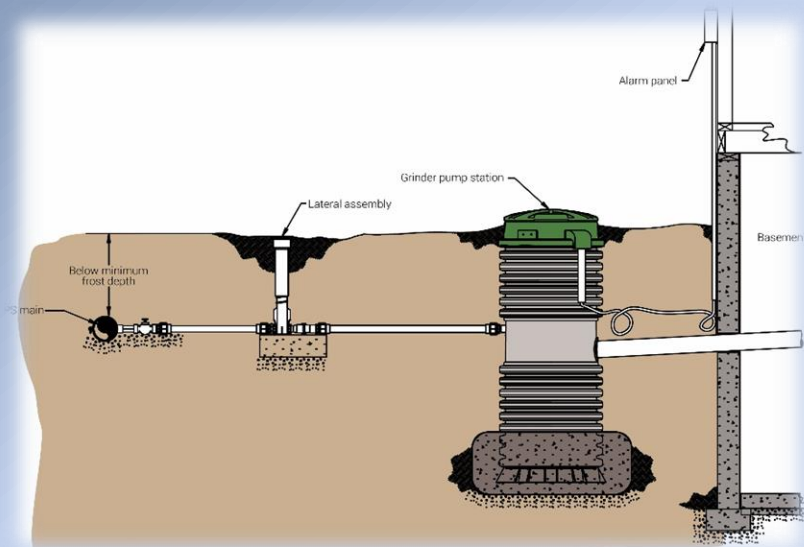

Typical Pump Station

SCHEDULE

- MILFORD FARMS/MOORE: START-APRIL 2024
 DURATION-18 MONTHS
- MEADOW CREEK: START-SEPT 2024
 DURATION-18 MONTHS
- EAGLEPOINTE: START-JULY 2024
 DURATION-10 MONTHS

COMMUNICATIONS

- Letters to Affected Residents
- Mailbox Hangers to Affected Residents
 - Township Newsletter
 - Township Website

ANY
QUESTIONS?



*Thank
you*

